

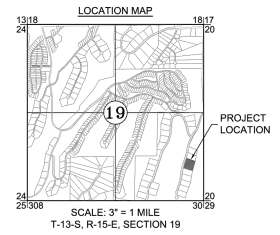

# RESULTS OF SURVEY

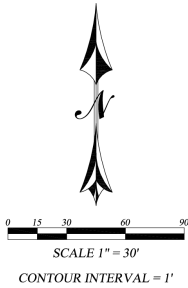

**LOT 80**  
**114-17-053B**  
4130 N. PAINTED QUAIL PLACE  
46,830.4 SQ. FT. ±  
1.12 ACRES ±  
OWNER: BARBARA GORES  
& JAMES BOULAY

**LOT 81**  
**114-17-054B**  
4160 N. PAINTED QUAIL PLACE  
45,415.2 SQ. FT. ±  
1.04 ACRES ±  
OWNER: BARBARA GORES  
& JAMES BOULAY



- LEGEND:**
- ✕ SET 40D NAIL (PINK FLAGGING) ON PROPERTY LINE (+/- 0.1')
  - ⊠ FOUND 2" BRASS CAP "RLS 19833 RW"
  - FOUND 5/8" IRON REBAR UNTAGGED UNLESS NOTED
  - ◇ FOUND 1/2" IRON REBAR "RLS 13178"
  - (M) MEASURED DATA
  - (R) RECORD PER BK.31 PG.62 MAPS AND PLATS
  - PROPERTY LINE
  - ADJACENT PROPERTY LINE
  - CENTERLINE ROAD
  - EASEMENT LINE
  - ⊠ ELECTRIC TRANSFORMER
  - ⊠ J BOX
  - ⊠ FIRE HYDRANT
  - ⊠ WATER VALVE
  - ⊠ TELEPHONE PEDESTAL
  - ⊠ CABLE T.V. PEDESTAL
  - ⊠ P.V.C. CONDUIT STUB OUT
  - ⊠ MESQUITE TREE
  - ⊠ PALO VERDE TREE
  - ⊠ OCOTILLO TREE
  - ⊠ SAQUARO CACTUS
  - ⊠ BARREL CACTUS
  - ⊠ ASPHALT PAVEMENT

CURVE	ARC LENGTH	RADIUS	DELTA ANGLE	CHORD BEARING	CHORD LENGTH
C1 (M)	134.97'	2012.90'	3°50'31"	N19°36'06"E	134.95'
C1 (R)	134.98'	2025.00'	3°49'09"	---	---
C2 (M)	19.20'	1172.43'	0°56'18"	S20°02'47"W	19.20'
C2 (R)	19.20'	1175.00'	0°56'11"	---	---
C3 (M)	167.56'	1172.43'	8°11'18"	S15°28'59"W	167.41'
C3 (R)	167.56'	1175.00'	8°10'14"	---	---
C4 (M)	51.79'	1172.43'	2°31'52"	S10°07'24"W	51.79'
C4 (R)	51.79'	1175.00'	2°31'31"	---	---

## NOTES

- THIS SURVEY WAS COMPLETED WITHOUT THE BENEFIT OF A UTILITY BLUESTAKE OR UTILITY PLAN RESEARCH. ALTHOUGH EVERY EFFORT WAS MADE BY THE SURVEYOR TO LOCATE ALL VISIBLE UTILITIES, THE LOCATION AND/OR EXISTENCE OF UTILITY SERVICE LINES BEYOND THOSE SHOWN ON THIS MAP IS UNKNOWN AND NOT SHOWN.
- THE SURVEYOR HAS MADE NO INVESTIGATION OR INDEPENDENT RESEARCH FOR EASEMENTS OF RECORD, ENCUMBRANCES, RESTRICTIVE COVENANTS, OWNERSHIP TITLE EVIDENCE, OR ANY OTHER FACTS THAT A CURRENT TITLE SEARCH MAY DISCLOSE. THE EASEMENTS SHOWN WERE FOUND ON THE SUBJECT PLAT AND AS SUPPLIED BY THE CLIENT.
- ALL DIMENSIONS SHOWN ON THIS MAP ARE MEASURED OR A CALCULATED DERIVATIVE THEREOF UNLESS STATED OTHERWISE.
- THE BASIS OF BEARINGS FOR THIS SURVEY IS A STRAIGHT LINE BETWEEN TWO FOUND MONUMENTS ON THE SOUTH LINE OF LOT 80 OF QUAIL CANYON AS SHOWN IN BOOK 31 PAGE 62 OF MAPS & PLATS, RECORDS OF PIMA COUNTY. THE BEARING OF SAID LINE IS N.74°29'43"W.
- THE BASIS OF ELEVATIONS FOR THIS SURVEY IS PIMA COUNTY OPUS BENCHMARK "13S15E\_P05", DESCRIBED AS A 2" BRASS CAP IN CONCRETE STAMPED "13S15E\_P05" IN THE INTERSECTION OF PAINTED QUAIL DRIVE AND PAINTED QUAIL PLACE, APPROXIMATELY 900 FEET NORTH OF THE SUBJECT PARCELS. THE ELEVATION OF SAID BENCHMARK IS 2,704.37' NAVD83 VERTICAL DATUM.
- THE CONTOUR INTERVAL IS 1 FOOT.
- THE TOPOGRAPHY AND PHOTOGRAPHY SHOWN ON THIS MAP WERE GENERATED FROM UAV PHOTOGRAPHY TAKEN WITH A DJI PHANTOM 4 AND PROCESSED WITH PIX4D SOFTWARE. THE UAV DRONE FLIGHT WAS PERFORMED ON 05/16/2018.

## VIEW ANGLE DESCRIPTIONS

- A CENTER
- B CATALINA MOUNTAINS, N.W.
- C CATALINA MOUNTAINS, NORTH
- D SABINO CANYON
- E REDDINGTON PASS
- F RINCON MOUNTAINS
- G VALUCOLOSSAL CAVE
- H SANTA RITA MOUNTAINS
- I GREEN VALLEY
- J "X" MOUNTAIN, DOWNTOWN
- K TWIN PEAKS
- L TUCSON MOUNTAINS

## CERTIFICATION OF SURVEY:

THIS IS TO CERTIFY THAT THIS SURVEY WAS PERFORMED UNDER MY DIRECTION DURING THE MONTH OF MAY 2018 AND THAT ALL MONUMENTS EXIST AS SHOWN



TODD A. HOUT  
REGISTERED LAND SURVEYOR  
ARIZONA REGISTRATION NO. 35543



ALTA ARIZONA

SURVEY - ENGINEERING - GEOTECH  
2025 W. RUTHRAUFF ROAD, SUITE 125  
TUCSON, ARIZONA 85705  
(520) 399-6651

FEE# \_\_\_\_\_ BOOK \_\_\_\_\_ SURVEY, PAGE \_\_\_\_\_

TOPOGRAPHICAL SURVEY OF LOT 80 & 81 OF QUAIL CANYON, IN BOOK 31  
OF MAPS & PLATS, PIMA COUNTY RECORDS, LOCATED IN SECTION 19,  
T-13-S, R-15-E OF THE G.&S.R.M., PIMA COUNTY, ARIZONA

PROJECT	Survey By: JCR	Drawn By: GWM	Checked By: TAH	Revision: GWM	Revision:	Revision:
NO. 18-229	Date: 5/17/18	Date: 5/31/18	Sheet: 1 of 1	Date: 6/5/18	Date:	Date: